

**ELECTRICAL SCHEMATIC**

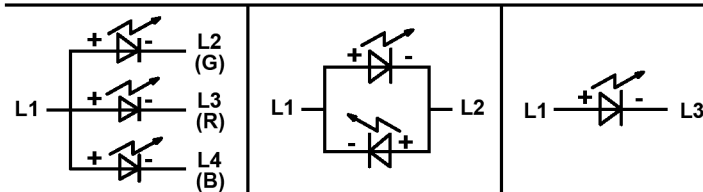
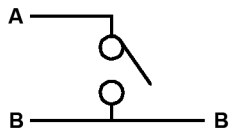

Compliance: RohS II (2011/65/EU)

Tolerances: $\pm 0.2$ mm	Date	Name	<b>TSLE 6868 R xyz</b>	<b>30 42 28</b>	Page
	04/19	dr			
			<b>knitter-switch</b>		1/2
Modifications	Date	Name			

**Specifications:**

**Contact rating:** 50 mA, 12 V DC  
**Contact resistance:** 100 mOhm max.  
**Insulation resistance:** 100 MOhm min. at 250 V DC  
**Dielectric strength:** 250 V AC (50/60 Hz) for 1 minute  
**Operating temperature:** -40°C to +85°C  
**Storage temperature:** -40°C to +85°C  
**Mechanical life:** 300 000 cycles  
**Electrical life:** 100 000 cycles  
**Operating force:** 200 +/-50 gf  
**Travel:** 0.70 +/-0.20 mm  
**Switch function:** momentary; normally open  
**Soldering conditions:** max.: 265°C, 5 sec.  
pre-heat max.: 100°C, 60 sec.  
**Sealing:** IP67  
**Material:** Plunger: silicone  
Cover: nickel-silver, thk. 0.20 mm  
Contact: stainless steel, 0.5 µm silver plated  
Base: PPA, white  
Terminal: C2680, 1.5 µm silver plated

x, y, z	Color
R	red
Y	yellow
G	green
B	blue
W	white
P	pure green
A	amber
N	no LED

Excepted RGB, all combinations end with one or two „N“  
 Example:  
 RGB RGB-LED  
 GNN one green LED  
 WAN a white and an amber LED  
 RYG not available, use RGB instead

**P.C.B. LAYOUT**  
(TOP VIEW)

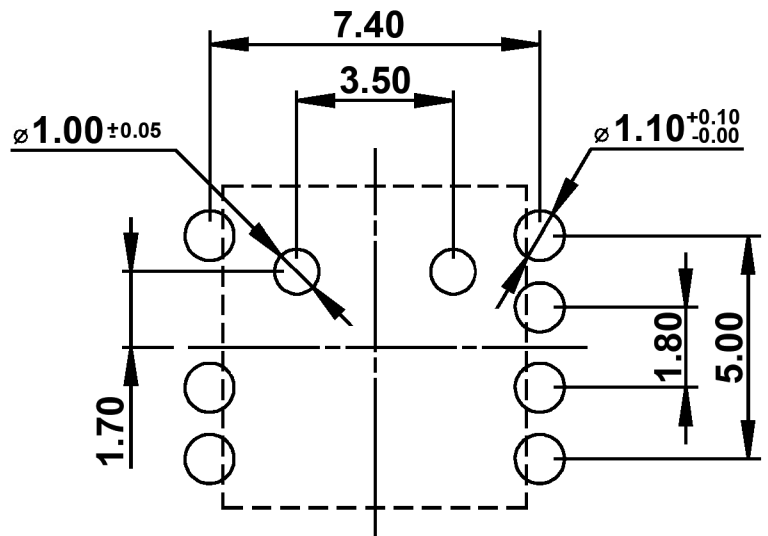

Compliance: RohS II (2011/65/EU)

Tolerances: ±0.2 mm	Date	Name	<b>TSLE 6868 R xyz</b>
	04/19	dr	
			<b>30 42 28</b>
			<b>knitter-switch</b>
			<b>30 42 28</b>
Modifications	Date	Name	Page 2/2